

Forged Steel Flanges

Carbon Steel • Stainless Steel • Special Alloys

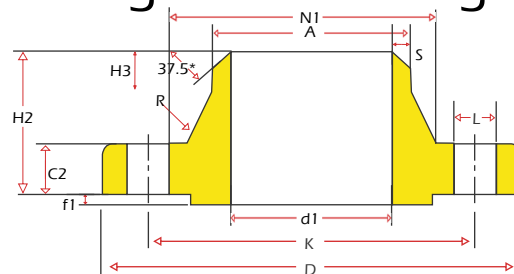
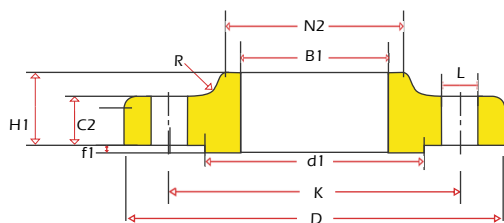

25 BAR Acc. to EN 1092-1

TYPE 12
SLIP-ON FLANGES

TYPE 11
WELD NECK FLANGES

TYPE 05
BLIND FLANGES

| Nominal Pipe Size | Outside Diameter | Pitch Circle Diameter | Size of Bolts | No. of Holes | Flange Thickness | | Length of Flanges | | | Corner Radius | Outside Diameter of Neck | Neck Diameter | Diameter of Shoulder | Raised Face Thickness | Neck Thickness | | | |
|-------------------|------------------|-----------------------|---------------|--------------|------------------|----|-------------------|-------------|----|---------------|--------------------------|---------------|----------------------|-----------------------|----------------|----|------|---|
| | | | | | 11 & 12 | 05 | 11, 12 & 05 | Flange Type | | | | | | | | | | |
| | | | | | | | | H1 | H2 | | | | | | | H3 | R | A |
| C2 | C4 | H1 | H2 | H3 | R | A | N1 | N2 | d1 | G | f1 | S | | | | | | |
| 15 | 95 | 65 | M12 | 4 | 16 | 16 | 22 | 38 | 6 | 4 | 21.3 | 32 | 35 | 45 | - | 2 | 2.0 | |
| 20 | 105 | 75 | M12 | 4 | 18 | 18 | 24 | 40 | 6 | 4 | 26.9 | 40 | 45 | 58 | - | 2 | 2.3 | |
| 25 | 115 | 85 | M12 | 4 | 18 | 18 | 26 | 40 | 6 | 4 | 33.7 | 46 | 52 | 68 | - | 2 | 2.6 | |
| 32 | 140 | 100 | M16 | 4 | 18 | 18 | 30 | 42 | 6 | 6 | 42.4 | 56 | 60 | 78 | - | 2 | 2.6 | |
| 40 | 150 | 110 | M16 | 4 | 18 | 18 | 32 | 45 | 7 | 6 | 48.3 | 64 | 70 | 88 | - | 2 | 2.6 | |
| 50 | 165 | 125 | M16 | 4 | 20 | 20 | 34 | 48 | 8 | 6 | 60.3 | 75 | 84 | 102 | - | 2 | 2.9 | |
| 65 | 185 | 145 | M16 | 8 | 22 | 22 | 38 | 52 | 10 | 6 | *76.1 | 90 | 104 | 122 | 55 | 2 | 2.9 | |
| 80 | 200 | 160 | M16 | 8 | 24 | 24 | 40 | 58 | 12 | 8 | 88.9 | 105 | 118 | 138 | 70 | 2 | 3.2 | |
| 100 | 235 | 190 | M20 | 8 | 24 | 24 | 44 | 65 | 12 | 8 | 114.3 | 134 | 145 | 162 | 90 | 2 | 3.6 | |
| 125 | 270 | 220 | M24 | 8 | 26 | 26 | 48 | 68 | 12 | 10 | *139.7 | 162 | 170 | 188 | 115 | 2 | 4.2 | |
| 150 | 300 | 250 | M24 | 8 | 28 | 28 | 52 | 75 | 12 | 10 | *168.3 | 192 | 200 | 218 | 140 | 2 | 4.5 | |
| 200 | 360 | 310 | M24 | 8 | 30 | 30 | 52 | 80 | 16 | 10 | 219.1 | 244 | 256 | 278 | 190 | 2 | 6.3 | |
| 250 | 425 | 370 | M27 | 12 | 32 | 32 | 60 | 88 | 18 | 12 | 273.0 | 298 | 310 | 335 | 235 | 2 | 7.1 | |
| 300 | 485 | 430 | M27 | 16 | 34 | 34 | 67 | 92 | 18 | 12 | 323.9 | 352 | 364 | 395 | 285 | 2 | 8.0 | |
| 350 | 555 | 490 | M30 | 16 | 38 | 38 | 72 | 100 | 20 | 12 | 355.6 | 398 | 418 | 450 | 332 | 2 | 8.0 | |
| 400 | 620 | 550 | M33 | 16 | 40 | 40 | 78 | 110 | 20 | 12 | 406.4 | 452 | 472 | 505 | 380 | 2 | 8.8 | |
| 450 | 670 | 600 | M33 | 20 | 46 | 46 | 84 | 110 | 20 | 12 | 457.0 | 500 | 520 | 555 | 425 | 2 | 8.8 | |
| 500 | 730 | 660 | M33 | 20 | 48 | 48 | 90 | 125 | 20 | 12 | 508.0 | 558 | 580 | 615 | 475 | 2 | 10.0 | |
| 600 | 845 | 770 | M36 | 20 | 58 | - | 100 | 125 | 20 | 12 | 610.0 | 660 | 684 | 720 | 575 | 2 | 11.0 | |
| 700 | 960 | 875 | M39 | 24 | 46 | - | - | 125 | 20 | 12 | 711.0 | 760 | - | 820 | - | 2 | 12.5 | |
| 800 | 1085 | 990 | M45 | 24 | 50 | - | - | 135 | 22 | 12 | 813.0 | 864 | - | 930 | - | 2 | 14.2 | |
| 900 | 1185 | 1090 | M45 | 28 | 54 | - | - | 145 | 24 | 12 | 914.0 | 968 | - | 1030 | - | 2 | 16.0 | |
| 1000 | 1320 | 1210 | M52 | 28 | 58 | - | - | 155 | 24 | 16 | 1016.0 | 1070 | - | 1140 | - | 2 | 17.5 | |

*All dimensions in mm.

* All weights indicated are approximate.

Other sizes available on request.

* The OD of the neck is suitable for ASTM A106 Piping

* For BS Standards Piping dimensions shall be 65mm = 76.1mm, 125mm = 139.7mm, 150mm = 168.3mm

While every care has been taken in the preparation of the information in this catalogue, the Company accepts no liability for any loss or damage either direct or consequential arising out of this catalogue. The compilation is for reference only, for further details please refer to the relevant standards.