

TYPE 12
SLIP-ON FLANGES

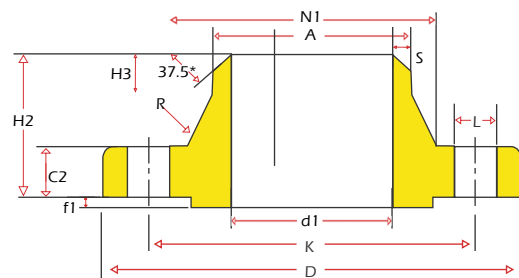

TYPE 11
WELD NECK FLANGES



TYPE 05
BLIND FLANGES

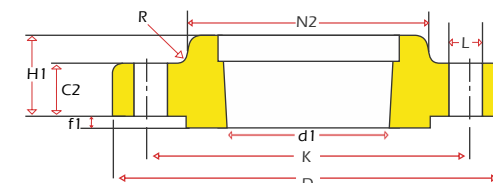

TYPE 13
THREADED FLANGES

16 BAR Acc. to EN 1092-1

Nominal Pipe Size	Outside Diameter	Pitch Circle Diameter	Size of Bolts	No. of Holes	Flange Thickness		Length of Flanges					Corner Radius		Outside Diameter of Neck	Neck Diameter			Diameter of Shoulder	Raised Face Thickness	Neck Thickness		
					11 & 12	13	05	11, 12 & 05		13	11 & 12	11 & 12	11, 12 & 05	13	11	11 & 12	11 & 12	13	11	05	11, 12 & 05	11
								C2	C4													
15	95	65	M12	4	16	16	16	22	22	38	6	4	4	21.3	32	35	35	45	-	2	2.0	
20	105	75	M12	4	18	18	18	26	26	40	6	4	4	26.9	40	45	45	58	-	2	2.3	
25	115	85	M12	4	18	18	18	28	28	40	6	4	4	33.7	46	52	52	68	-	2	2.6	
32	140	100	M16	4	18	18	18	30	30	42	6	6	6	42.4	56	60	60	78	-	2	2.6	
40	150	110	M16	4	18	18	18	32	32	45	7	6	6	48.3	64	70	70	88	-	2	2.6	
50	165	125	M16	4	18	18	18	28	28	45	8	6	5	60.3	74	84	84	102	-	2	2.9	
65	185	145	M16	8**	18	18	18	32	32	45	10	6	6	*76.1	92	104	104	122	55	2	2.9	
80	200	160	M16	8	20	20	20	34	34	50	10	8	6	88.9	105	118	118	138	70	2	3.2	
100	220	180	M16	8	20	20	20	40	40	52	12	8	6	114.3	131	140	140	158	90	2	3.6	
125	250	210	M16	8	22	22	22	44	44	55	12	8	8	*139.7	156	168	168	188	115	2	4.0	
150	285	240	M20	8	22	22	22	44	44	55	12	10	8	*168.3	184	195	195	212	140	2	4.5	
200	340	295	M20	12	24	-	24	44	-	62	16	10	10	219.1	235	246	-	268	190	2	5.6	
250	405	355	M24	12	26	-	26	46	-	70	16	12	-	273.0	292	298	-	320	235	2	6.3	
300	460	410	M24	12	28	-	28	46	-	78	16	12	-	323.9	344	350	-	378	285	2	7.1	
350	520	470	M24	16	30	-	30	57	-	82	16	12	-	355.6	390	400	-	438	330	5	8.0	
400	580	525	M27	16	32	-	32	63	-	85	16	12	-	406.4	445	456	-	490	380	5	8.0	
450	640	585	M27	20	40	-	40	68	-	87	16	12	-	457.0	490	502	-	550	425	5	8.0	
500	715	650	M30	20	44	-	44	73	-	90	16	12	-	508.0	548	559	-	610	475	2	8.0	
600	840	770	M33	20	54	-	54	83	-	95	18	12	-	610.0	652	658	-	725	575	2	8.8	
700	910	840	M33	24	36	-	48	83	-	100	18	12	-	711.0	755	760	-	795	670	2	8.8	
800	1025	950	M36	24	38	-	52	90	-	105	20	12	-	813.0	855	864	-	900	770	2	10.0	
900	1125	1050	M36	28	40	-	58	94	-	110	20	12	-	914.0	955	968	-	1000	880	2	10.0	
1000	1255	1170	M39	28	42	-	64	100	-	120	22	16	-	1016.0	1058	1072	-	1115	960	2	10.0	

* All Dimensions in mm.

Other sizes available on request.

* The OD of the neck is suitable for ASTM A106 Piping

* For BS Standards Piping dimensions shall be 65mm = 76.1mm, 125mm = 139.7mm, 150mm = 168.3mm

** Subject to agreement between the Manufacturer and the Purchaser 4 holes can be used for PN16, DN65 Steel Flanges

While every care has been taken in the preparation of the information in this catalogue, the Company accepts no liability for any loss or damage either direct or consequential arising out of this catalogue. The compilation is for reference only, for further details please refer to the relevant standards.