

Forged Steel Flanges

Carbon Steel • Stainless Steel • Special Alloys

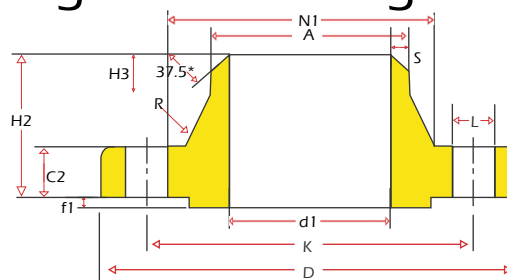
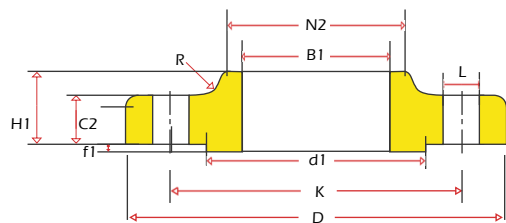

10 BAR Acc. to EN 1092-1

TYPE 12
SLIP-ON FLANGES

TYPE 11
WELD NECK FLANGES

TYPE 05
BLIND FLANGES

Nominal Pipe Size	Outside Diameter	Pitch Circle Diameter	Size of Bolts	No. of Holes	Flange Thickness		Length of Flanges					Corner Radius	Outside Diameter of Neck	Neck Diameter		Diameter of Shoulder		Raised Face Thickness	Neck Thickness
					11 & 12	05	11 & 12	11 & 12	11 & 12	11, 12 & 05	11	11 & 12	11 & 12	11	05	11, 12 & 05	11		
					C2	C4	H1	H2	H3	R	A	N1	N2	d1	G	f1	S		
15	95	65	M12	4	16	16	22	38	6	4	21.3	32	35	40	-	2	2.0		
20	105	75	M12	4	18	18	26	40	6	4	26.9	40	45	50	-	2	2.3		
25	115	85	M12	4	18	18	28	40	6	4	33.7	46	52	60	-	2	2.6		
32	140	100	M16	4	18	18	30	42	6	6	42.4	56	60	70	-	2	2.6		
40	150	110	M16	4	18	18	32	45	7	6	48.3	64	70	80	-	2	2.6		
50	165	125	M16	4	20	20	28	45	8	6	60.3	75	84	90	-	2	2.9		
65	185	145	M16	8**	18	18	32	45	10	6	*76.1	92	104	110	55	2	2.9		
80	200	160	M16	8	20	20	34	50	10	8	88.9	105	118	128	70	2	3.2		
100	220	180	M16	8	20	20	40	52	12	8	114.3	131	140	148	90	2	3.6		
125	250	210	M16	8	22	22	44	55	12	8	*139.7	156	168	178	115	2	4.0		
150	285	240	M20	8	22	22	44	55	12	10	*168.3	184	195	202	140	2	4.5		
200	340	295	M20	8	24	24	44	62	16	10	219.1	235	246	258	190	2	6.3		
250	395	350	M20	12	26	26	46	68	16	12	273.0	292	298	312	235	2	6.3		
300	445	400	M20	12	26	26	46	68	16	12	323.9	342	350	365	285	2	7.1		
350	505	460	M20	16	26	26	53	68	16	12	335.6	385	400	415	330	2	7.1		
400	565	515	M24	16	26	26	57	72	16	12	406.4	440	456	465	380	2	7.1		
450	615	565	M24	20	28	28	63	72	16	12	457.0	488	502	520	425	2	7.1		
500	670	620	M24	20	28	28	67	75	16	12	508.0	542	559	570	475	2	7.1		
600	780	725	M27	20	28	34	75	80	18	12	610.0	642	658	670	575	2	7.1		
700	895	840	M27	24	30	38	-	80	18	12	711.0	746	-	775	670	2	8.0		
800	1015	950	M30	24	32	42	-	90	18	12	813.0	850	-	880	770	2	8.0		
900	1115	1050	M30	28	34	46	-	95	20	12	914.0	950	-	980	860	2	10.0		
1000	1230	1160	M33	28	34	52	-	95	20	16	1016.0	1052	-	1080	960	2	10.0		

*All dimensions in mm.

*All weights indicated are approximate.

Other sizes available on request.

*The OD of the neck is suitable for ASTM A106 Piping

*For BS Standards Piping dimensions shall be 65mm = 76.1mm, 125mm = 139.7mm, 150mm = 168.3mm

** Subject to agreement between the Manufacturer and the Purchaser 4 holes can be used for PN10, DN65 Steel Flanges

While every care has been taken in the preparation of the information in this catalogue, the Company accepts no liability for any loss or damage either direct or consequential arising out of this catalogue. The compilation is for reference only, for further details please refer to the relevant standards.