

# 25 BAR

Acc. to BS EN 1092-1

## WELD NECK FLANGES SLIP-ON FLANGES

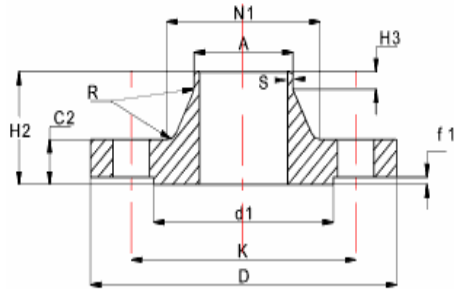

TYPE 11

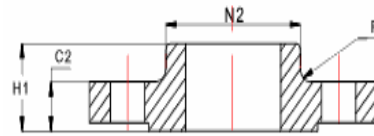

TYPE 12

NPS	D	K	Size	No.	C2	H1	H2	H3	R	A	N1	N2	d1	f1	S
15	95	65	M12	4	14	20	35	6	4	21.3	32	35	45	2	2.0
20	105	75	M12	4	14	24	38	6	4	26.9	39	45	58	2	2.3
25	115	85	M12	4	16	24	38	6	4	33.7	46	52	68	2	2.6
32	140	100	M16	4	16	26	40	6	6	42.4	56	60	78	2	2.6
40	150	110	M16	4	16	26	42	7	6	48.3	64	70	88	2	2.6
50	165	125	M16	4	20	34	48	8	6	60.3	75	84	102	2	2.9
65	185	145	M16	8	22	38	52	10	6	76.1	90	104	122	2	2.9
80	200	160	M16	8	24	40	58	12	8	88.9	105	118	138	2	3.2
100	235	190	M20	8	24	44	65	12	8	114.3	134	145	162	2	3.6
125	270	220	M24	8	26	48	68	12	10	139.7	162	170	188	2	4.2
150	300	250	M24	8	28	52	75	12	10	168.3	192	200	218	2	4.5
200	360	310	M24	12	30	52	80	16	10	219.1	244	256	278	2	6.3
250	425	370	M27	12	32	60	88	18	12	273.0	298	310	335	2	7.1
300	485	430	M27	16	34	67	92	18	12	323.9	352	364	395	2	8.0
350	555	490	M30	16	38	72	100	20	12	355.6	398	418	450	2	8.0
400	620	550	M33	16	40	78	110	20	12	406.4	452	472	505	2	8.8
450	670	600	M33	20	46	84	110	20	12	457.0	500	520	555	2	8.8
500	730	660	M33	20	48	90	125	20	12	508.0	558	580	615	2	10.0
600	845	770	M36	20	58	100	125	20	12	610.0	660	684	720	2	11.0
700	960	875	M39	24	46	-	125	20	12	711.0	760	-	820	2	12.5
800	1085	990	M45	24	50	-	135	22	12	813.0	864	-	930	2	14.2
900	1185	1090	M45	28	54	-	145	24	12	914.0	968	-	1030	2	16.0
1000	1320	1210	M52	28	58	-	155	24	16	1016.0	1070	-	1140	2	17.5

\* All Dimensions in mm.

- DN Nominal Size
- K Pitch Circle Diameter
- SIZE Size of Bolts
- No Number of Holes
- C2 Thickness of Weld Neck & Slip-on Flange
- H1 Length of Slip-on Flange
- H2 Length of Weld Neck Flange
- H3 Length of Neck
- R Corner Radius
- A Outside Diameter of Neck
- N1 Diameter of Weld Neck
- N2 Diameter of Slip-on Flange